

FONA X70

Designed for ease of use, stable image quality and a long lifespan, FONA X70 is the ideal affordable solution for your dental studio.

Its automatic correction for mains voltage fluctuations, full protection against tube over-heating with accurate cool-down procedure, and improved safety features will make FONA X70 your reliable imaging companion for years to come.



Stable image quality

A penetration power of 70 kV and microprocessor controlled timer guarantee good image contrast and consistent film blackening.



Intuitive use

Automatic setting of exposure times from 60 ms to 3.2 s, according to the tooth type and patient size selected.



Proven reliability

Protection against tube overheating gives the unit a long life, making your investment a secure one.

The image shows a white dental X-ray unit, the FONA X70, against a light blue background. The unit consists of a long, articulated arm that can be extended and retracted. At the end of the arm is a large, white, rectangular X-ray tube head. Below the arm is a control panel with a digital display showing '0.10' and several buttons. A coiled cable is attached to the bottom of the control panel. Three callout boxes with teal borders and dots point to different parts of the unit: 'PROVEN RELIABILITY' points to the arm, 'STABLE IMAGE QUALITY' points to the X-ray tube head, and 'INTUITIVE USE' points to the control panel.

PROVEN RELIABILITY

Thousands of units installed worldwide provide intraoral imaging every day.

STABLE IMAGE QUALITY

Even in the most demanding working conditions.

INTUITIVE USE

Simple control panel for automatic exposure setting.

Technical Specifications

	FONA X70	FONA XDG	FONA XDC
Generator	Alternating Current (AC)	Alternating Current (AC)	Direct Current (DC)
Focal spot	0.8 (IEC 336/1997)	0.4 (IEC 336/1997)	0.4 (IEC 336/1997)
Tube voltage, tube current	70 kVp, 7 mA	70 kVp, 3.5 mA	60/70 kV (selectable), 7 mA
Line voltage	120/230 V, 50/60 Hz	120/230 V, 50/60 Hz	100/230V, 50/60 Hz
Focus - skin distance	Standard 21 cm	Standard 21 cm	Standard 20 cm (optional 30 cm)
Exposure time	0.06 – 3.2 s	0.21 - 11.2 mAs	0.01 – 3.2 s / 0,07 – 22,4 mAs
Patient Sizes	Adult, Child	Adult, Child	Adult, Child
Number of anatomical regions	7	7	9

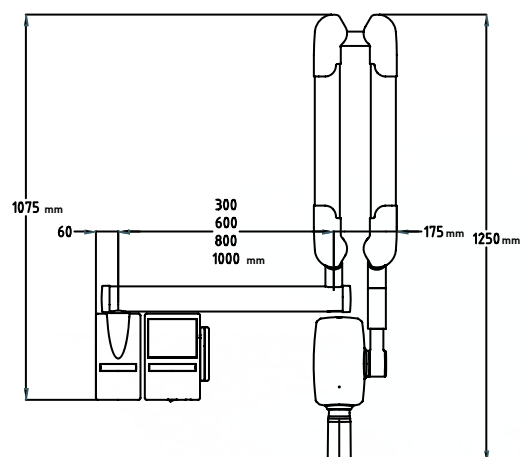
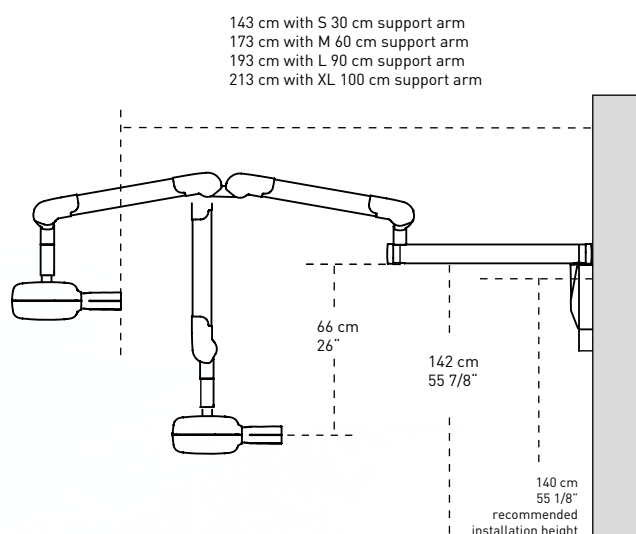

Wall mounted version available in four different extension arm lengths: 30cm, 60cm, 80cm, 100cm

